

# HDJ-K90-15

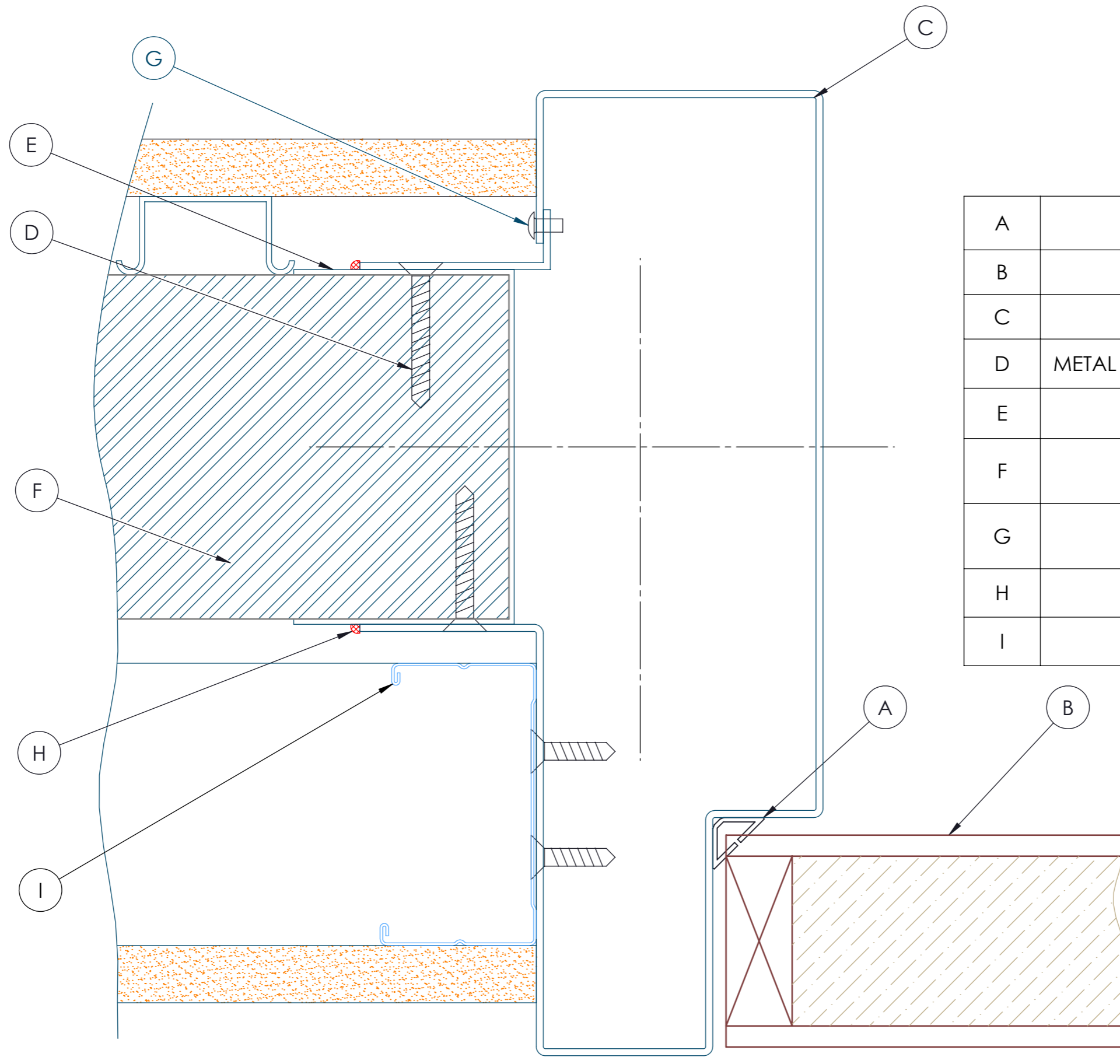

A	LAS1212
B	48mm EUROPA DOOR
C	STEEL JAMB (MUST BE BACKFILLED)
D	METAL TEK SCREWS 10G X 30mm @ 300mm CENTRES
E	STANDARD KOROK C- SECTION
F	KOROK/SPEEDWALL - 78mm
G	3mm STEEL RIVETS @ 300mm CENTRES
H	FIRE RATED SEALANT
I	STEEL STUD

CORE	EUROPA
FRR	-/90/30 sm
JAMB "J"	SW1
WALL TYPE EXAMPLES	KOROK

Title: <b>Door Jamb</b>	Date: 19/01/2021	Drawn By: HM	Checked By: HM
Drawing No: <b>HDJ-K90-15</b>	Revision: 1.0	Sheet No: 1 / 1	Size: A3

